HIGH BALL

A Publication for the Mid-Michigan Railroad Club
April 2024



Business Meeting at the American Legion 7475 B Drive North Battle Creek Saturday April 20
Time not set yet.

Think Safety

- Equipment owners if you have not inspected your equipment now is a good time to do it. Please put your notes of what equipment was inspected in the file cabinet in the barn.
- The track needs to be walked before all run days. Look for debris on the track and damage due to things like golf carts.
- **PLEASE NOTE:** It is up to EVERY MEMBER to remain alert and proactive to the cause of safe operation and good personal conduct at ALL TIMES.

Projects

Saturdays in April are work days weather permitting. Here are some key projects we need volunteers for:

- All four bridge decks are still in need of a coat of weather sealer like boiled Linseed oil. This can be sprayed, brushed or rolled onto the surface. Products like Linseed oil can be slippery for some time after application so some anti-slip grit sprinkled into the surface would be a good idea. We need a volunteer(s) to pick up the sealer and get it applied. Talk to Rod Pitman or Chris Morris about materials costs.
- Tie replacement. A program of going through the track each year replacing ties keep the track structure in good repair. We have plenty of ties and screws. This is something an individual or a couple people can work on together almost any time (scheduled work day or not). For the shady areas that do not dry well we have plastic ties.

- The new barn (old pavilion) is nearly completed. The top along the sides and at the end wall need translucent panels to give some natural light as well as sealing out the weather and the sparrows. We need someone to take charge:
 - Source translucent panels and get a materials cost to the board members.
 - Once approved buy the materials.
 - With some help get the panels installed.



- A new track panel jig for the plastic ties. We need a jig that will place the plastic ties on their sides at a 3" interval. We need a volunteer to source materials and build the jig. Our existing jigs will give a good example of what is needed. Check with Rod Pitman or Chris Morris on materials costs.



- The north end of the long wood bridge needs an additional bent installed. We have a spare bent down by the barn. A small footing is needed and bent installed. The existing bents will be an example of the size. We need a volunteer to pick up the materials, round up a couple helpers, form the footings, pour some pre-mix concrete and install the bent.



- Annual inspection of the club equipment.
 - Bearings in good condition.
 - Safety chains and eye installed. Eyes secure (not loose).
 - Check for loose bolts and fasteners.
 - Check for loose parts.
- Mower, service truck and air compressor service.
 - Check/change oil in all the gas engines.
 - Check lube oil in the air compressor.
 - Air up the tires.
 - Tag the service date on the equipment.

- Grass mowing. The trade off for warmer weather is we will soon be mowing and trimming. Help is always needed.

IBLS Safety Chain Standards

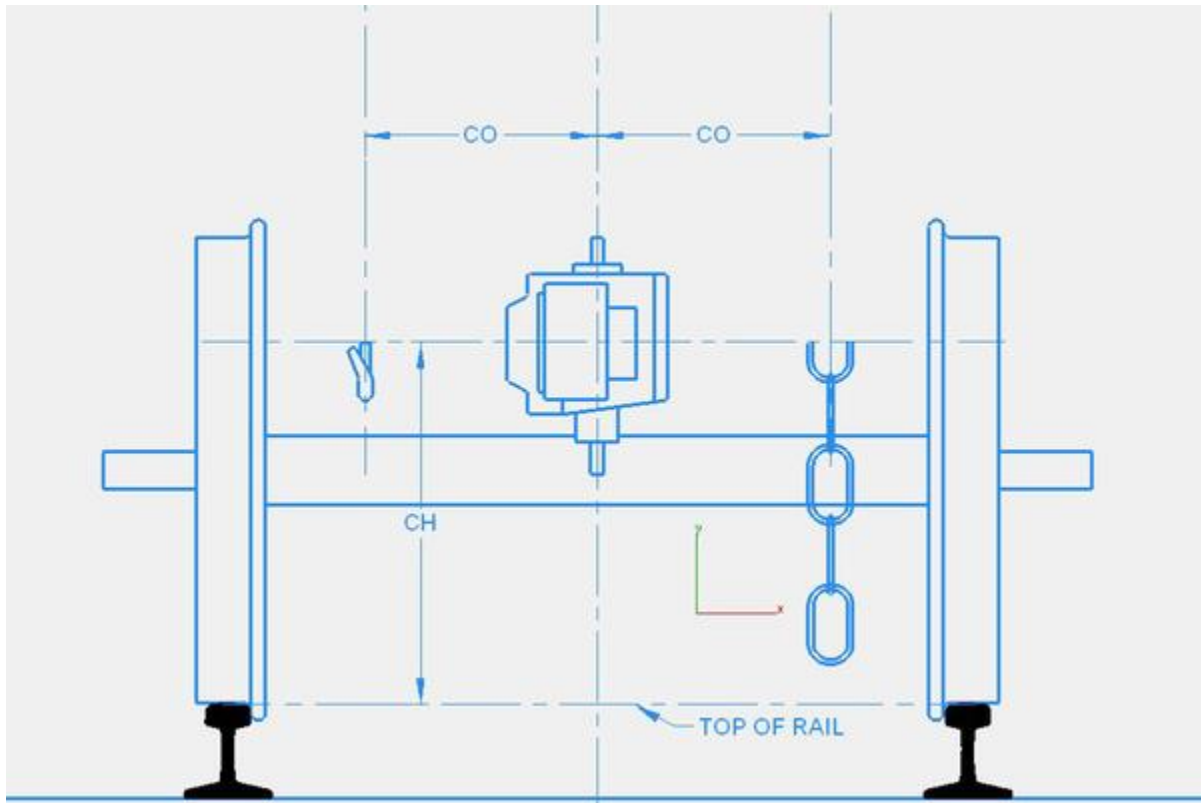

Scale	Gauge	Coupler/Chain Hook Height (CH)	Chain Offset (CO)	Hook Size	Link Size	Chain Length
1/2"	2-1/2"	1-15/16				
3/4"	3-1/2"	2-1/4				
1"	4-3/4"	2-7/8" +/- 1/4"	1-1/4"	0.11"		3-1/2" +/- 1/2"
1"	5"	3-1/4" +/- 1/4"	1-1/4"	0.11"		3-1/2" +/- 1/2"
1-1/2"	7-1/4"	4-7/16" +0" -3/16"	2-1/2" +/- 1/4"	1/4"	1/8"x1" welded	7" +/- 1"
1-1/2"	7-1/2"	4-7/16" +0" -3/16"	2-1/2" +/- 1/4"	1/4"	1/8"x1" welded	7" +/- 1"
1.6"	7-1/2"	4-7/16" +0 -3/16"	2-1/2" +/- 1/4"	1/4"	1/8"x1" welded	7" +/- 1"
2.5"	7-1/4"+	5.4"				
3"	12"	7.5"				

IBLS Wheel Standard

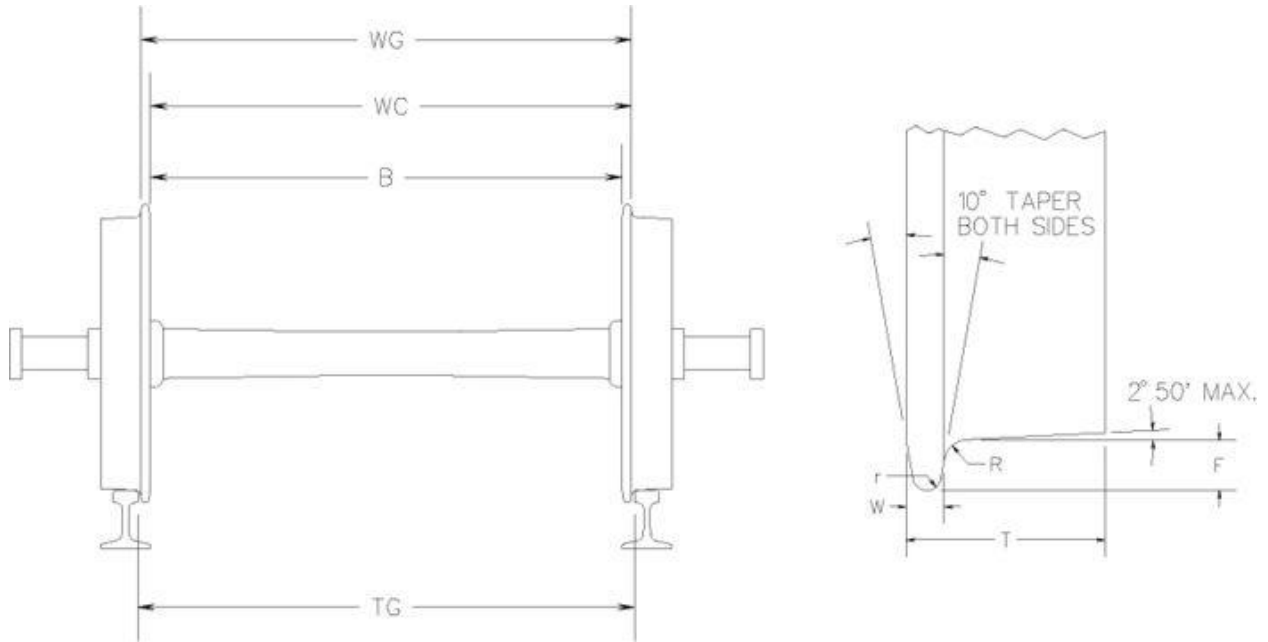

IBLS Wheel Standards

Scale	TG=Track Gauge	T=Tire Width	W=Flange Width	F=Flange Depth	R=Contour Radius	r=Flange Radius	B=Back to back	WG=Wheel Gauge	WC=Wheel Check
1/2" (17/32")	2.500 min	9/32 min	0.063 max	0.075 max	0.025 min, 0.033 max	0.030 typ	2-9/32 +0.200 -0.000	2-15/32 +0.000 -0.020	2.405 ref
3/4"	3.500 min	0.406 min	0.094 max	0.094 max	0.047 min, 0.063 max	0.040 typ	3.281 +0.020 -0.000	3.470 +0.000 -0.020	3.375 ref
1"	4.750 min	0.505 min	0.125 max	0.140 max	0.062 min, 0.083 max	0.050 typ	4.437 +0.020 -0.000	4.690 +0.000 -0.020	4.562 ref
1"	5.000 min	0.505 min	0.125 max	0.140 max	0.062 min, 0.083 max	0.050 typ	4.687 +0.020 -0.000	4.940 +0.000 -0.020	4.812 ref
1-1/2"	7.250 min	0.750 min	0.156 max	0.187 max	0.094 min, 0.125 max	0.062 typ	6.870 +0.020 -0.000	7.190 +0.000 -0.020	7.031 ref
1-1/2"	7.500 min	0.750 min	0.156 max	0.187 max	0.094 min, 0.125 max	0.062 typ	7.120 +0.020 -0.000	7.440 +0.000 -0.020	7.281 ref
1.6"	7.500 min	0.750 min	0.156 max	0.187 max	0.094 min, 0.125 max	0.062 typ	7.120 +0.020 -0.000	7.440 +0.000 -0.020	7.281 ref

2024 Run Schedule

April Saturday Work Days (weather permitting)

May 4-5, 11-12, 18-19 Arts & Crafts Show

June 8-9

July 6-7, 20-21

August 3-4, 17-18

September 14-15, 21-22 Flea Market and Antiques Show

October 5-6, 12-13, 19-20, 26-27

2024 Dues are due.

Annual dues are due. Please send them to Chris Morris 421 N Shelton St. Charlotte MI 48813-1224.

MMRC Facebook Page

Looking for three more volunteers at a minimum who run a train on the MMRC to share more about how their engine works (and some pictures of the internal workings along with the exterior of the engine). Goal is to increase knowledge to the public and retain interest on how trains operate. Would love a steam, electric, gas, hybrid. Contact Tina Pritchard, Membership Secretary if you can help.

For Sale Items for the newsletter?

Send details to Pat Patton, patpatton@ymail.com

Officers

President	Rod Pitman 269-720-0396 rrhotcold@aol.com
Vice President	Pat Kinney 269-753-4177 patk1977@aol.com
Treasurer	Chris Morris 517-543-8279 cm61654@gmail.com
Membership Secretary	Tina Pritchard tina@bretina.net
Corresponding Secretary	Mike Schmitzer 269-274-4366 mstrains@att.net
Safety	Ted Hentchel 269- 945-7628 tedhentchel@yahoo.com